



INSPIRATION  
DESIGN BOOK  
2023

LANDSCAPE

CONTEMPORARY

BETWEEN

OUTDOOR



MONUMENTAL

ART ARCHIVE

SPACES

LIVING

ART

AND

CULTURE



# CONTENTS



2023

06

## RALPH - noche

Inspired By: Saudi Arabia, Maraya Concert Hall

16

## MORGAN

Inspired By: Turkey, Basilica Cistern

26

## SWAN

Inspired By: USA, Lacma Museum

34

## FINOL

Inspired By: Argentina, Palacio Barolo

42

## RALPH

Inspired By: Austria, Felsenreitschule

50

## PIGALLE

Inspired By: Morocco, Marrakech

58

## BAIXA

Inspired By: Israel, Dibbuk at Geshen Theatre

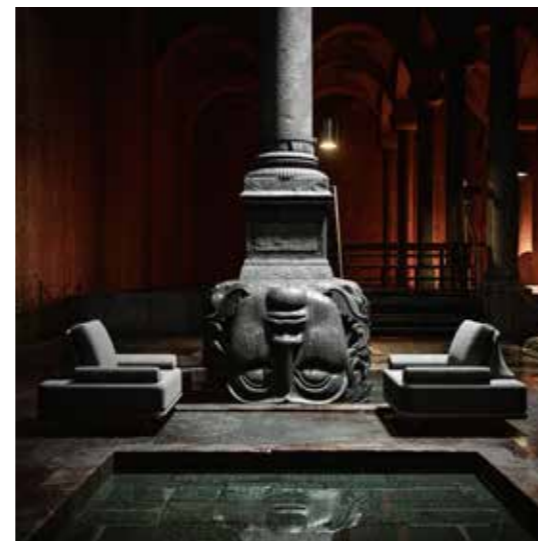

WE FIND ITS BALANCE IN  
THE WORLD'S PLAYGROUND.

IN THE SEESAW GAME WITH THE  
WORLD, BY WEIGHING ITSELF AGAINST  
THE WHOLE WORLD AND NATURE

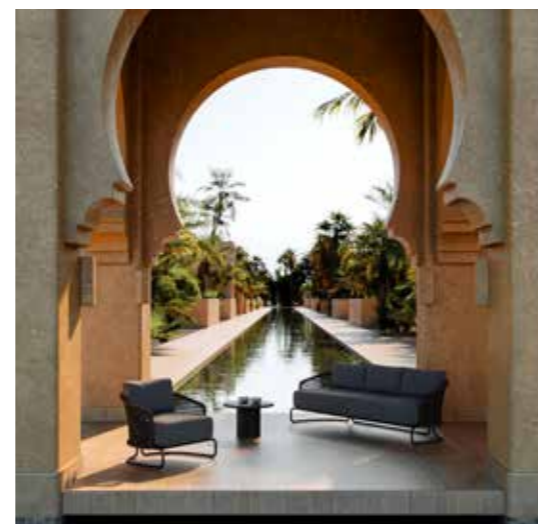

RALPH-noche

A STONE IN OUR LIVES LIKE A ROCK  
CAST UPON THE WATERS



REFLECTIVE

INTERACTIONS

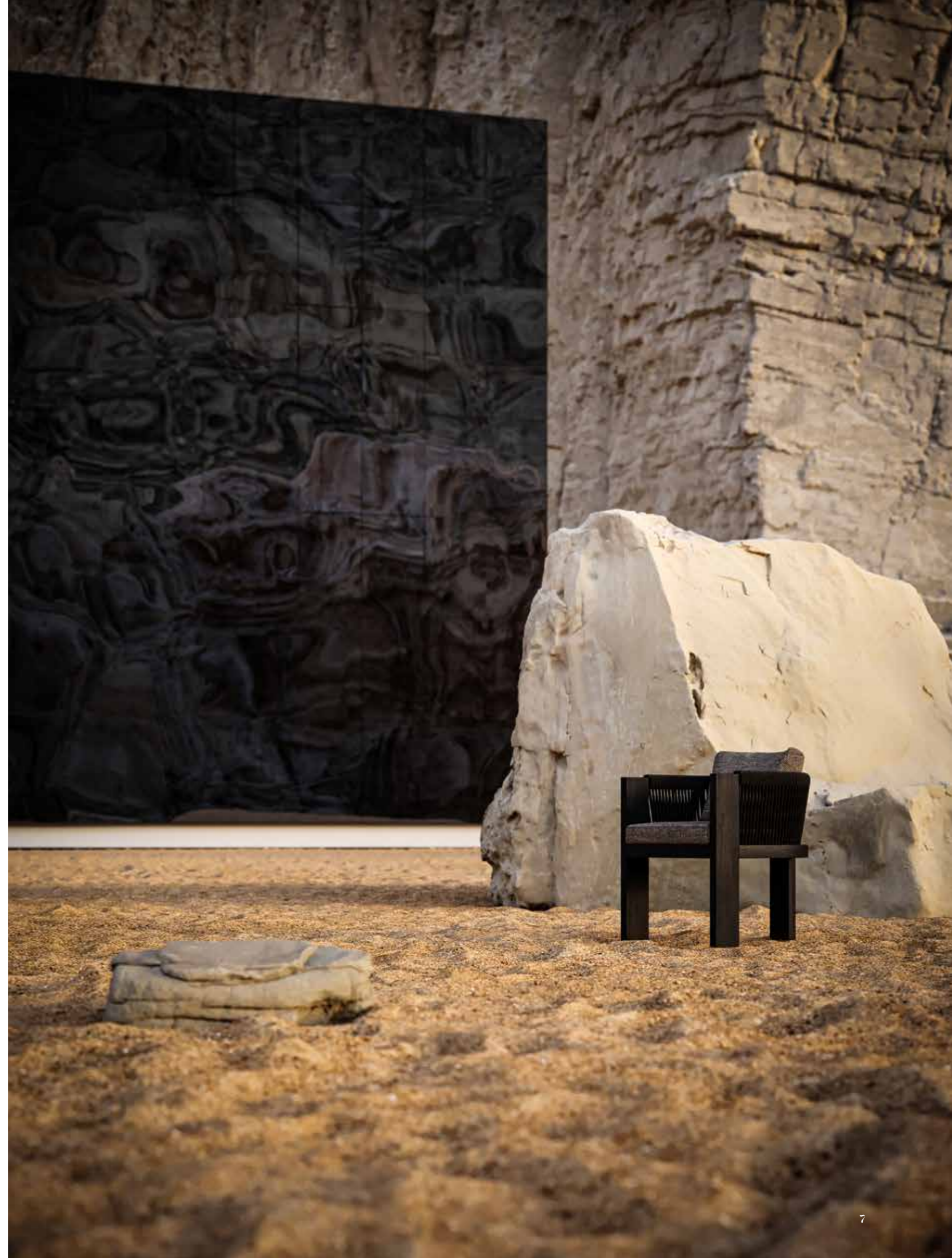

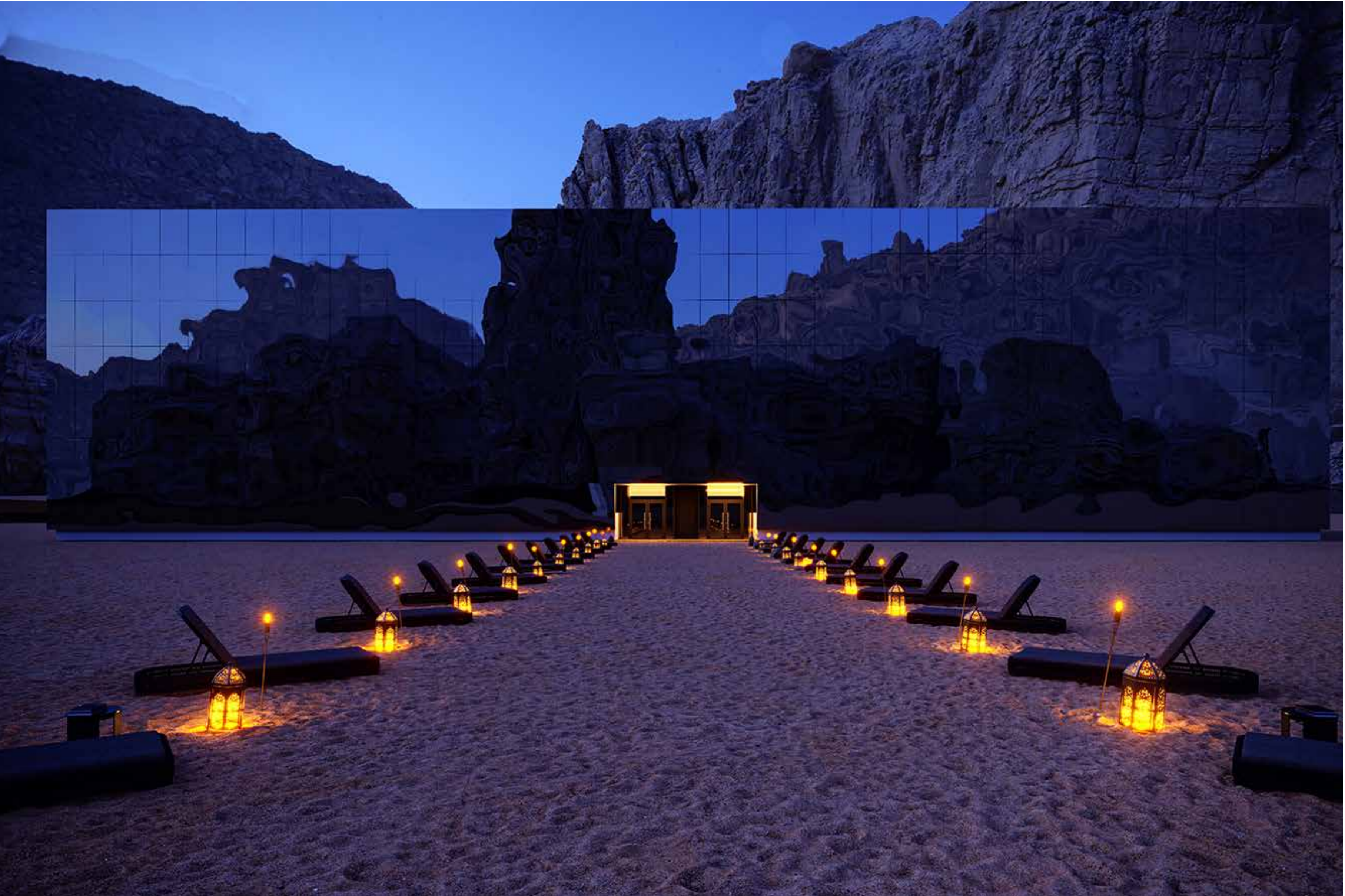



This landscape inspired architecture and land art form the Nabataeans to today. This is an architectural work of land art, a vision created by the extraordinary natural and social history around it. The building is site specific landmark of true land art and architecture.



BETWEEN NATURE, HISTORY AND THE FUTURE  
THE INSTALLATION OF ART

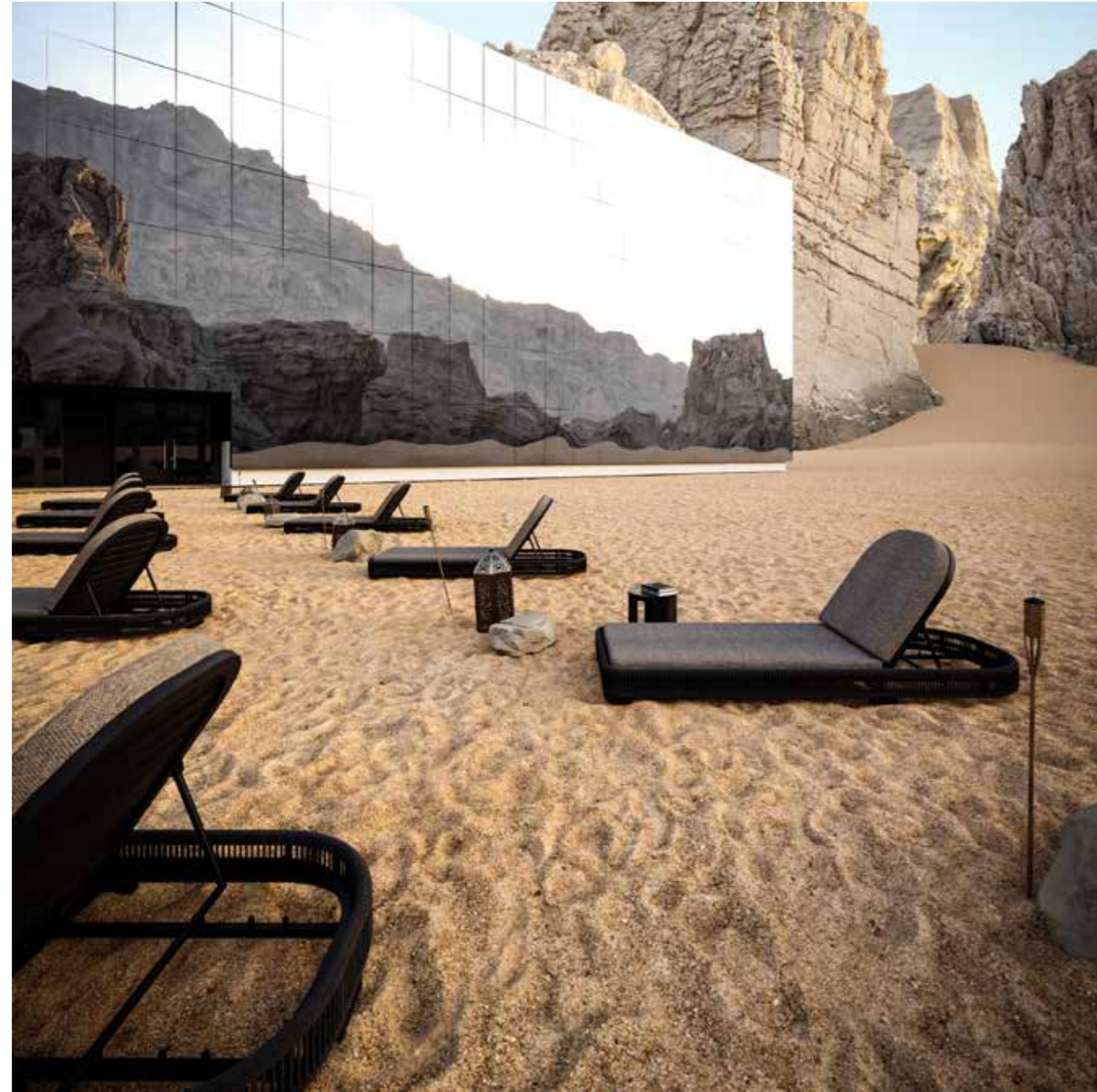

RADICAL

REFLECTIONS



Ralph-noche Collection consists of a lounge set, dining set, chaise lounge and coffee tables designed with teak wood and acrylic rope details that gracefully express a unique synthesis of aesthetics, functionality and ergonomics. The collection, which has turned into an iconic design, provides integrity in the perception of visual flow with framed design details, strong thick lines. It is enriched with cushion details in tones compatible with black teak color and offers a new and special interpretation to your outdoor areas.



MORGAN

DESIGN

OF

DESIRE

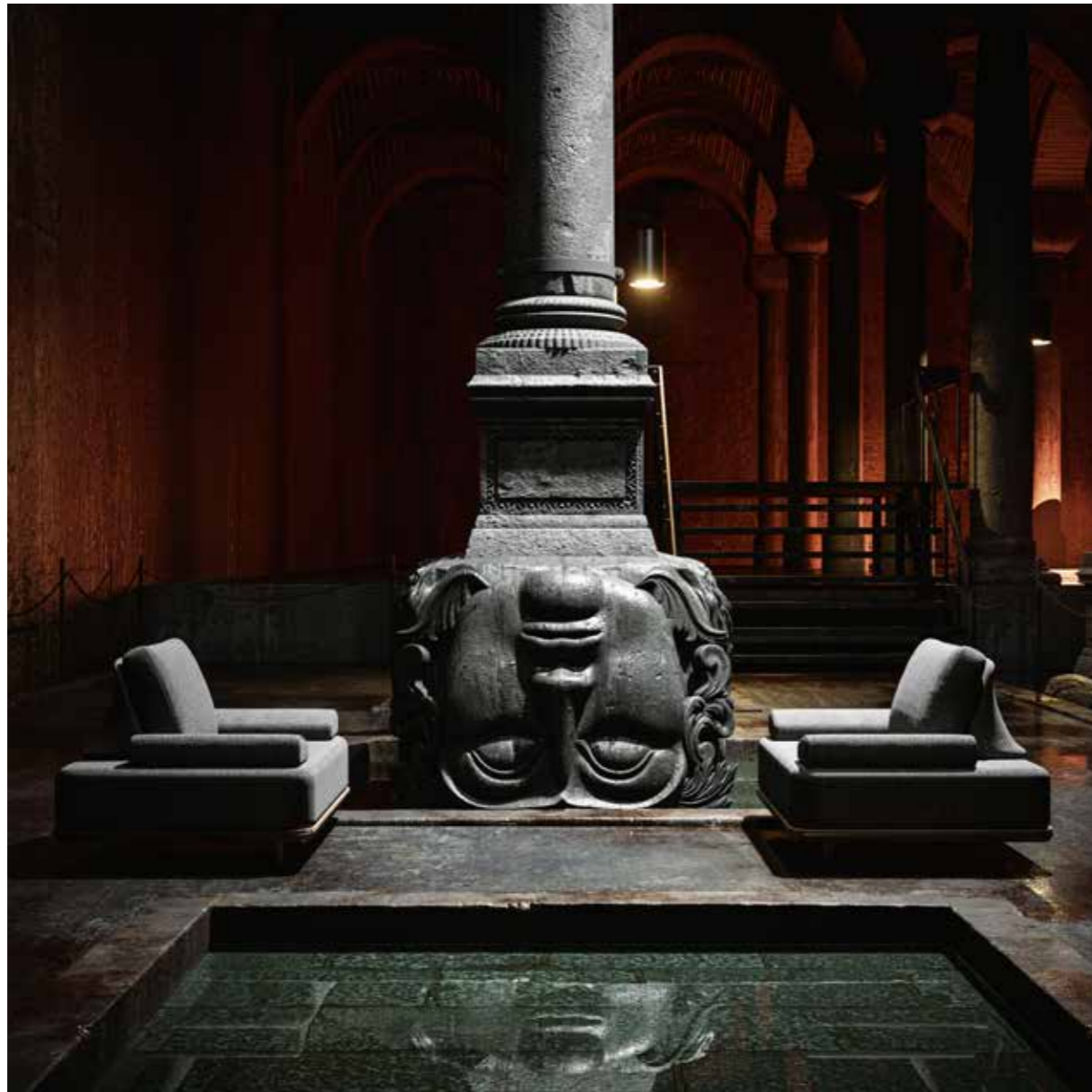

THE  
POWER

BEAUTY  
OF

AND  
MEDUSA

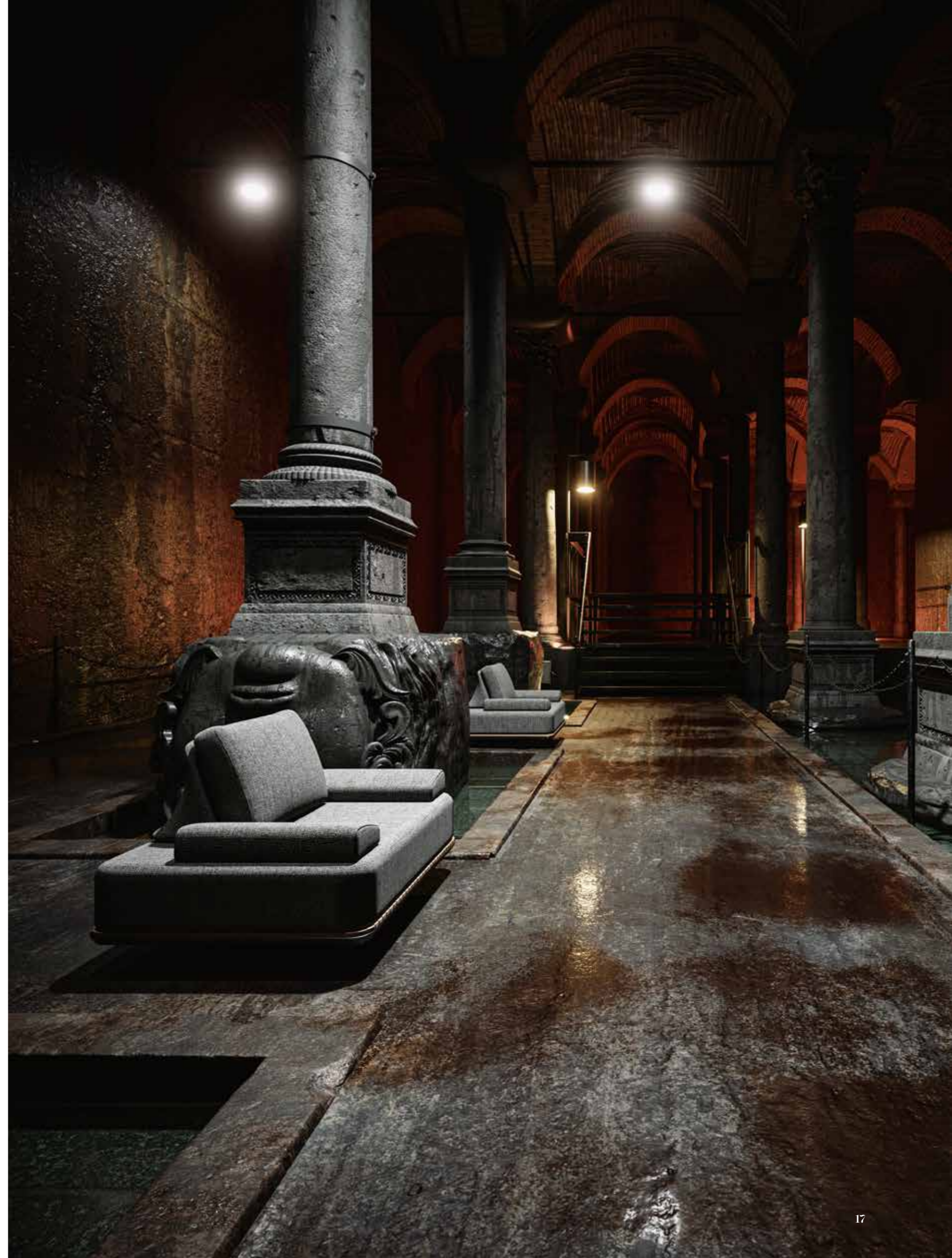



TO REALIZE THAT THE MEDUSA'S

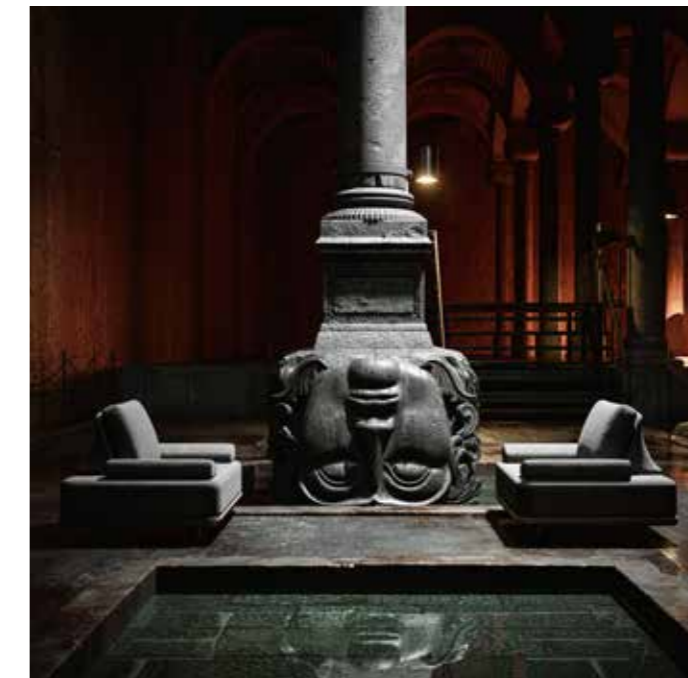

BEAUTY IS MORE DIFFERENT PHENOMENON





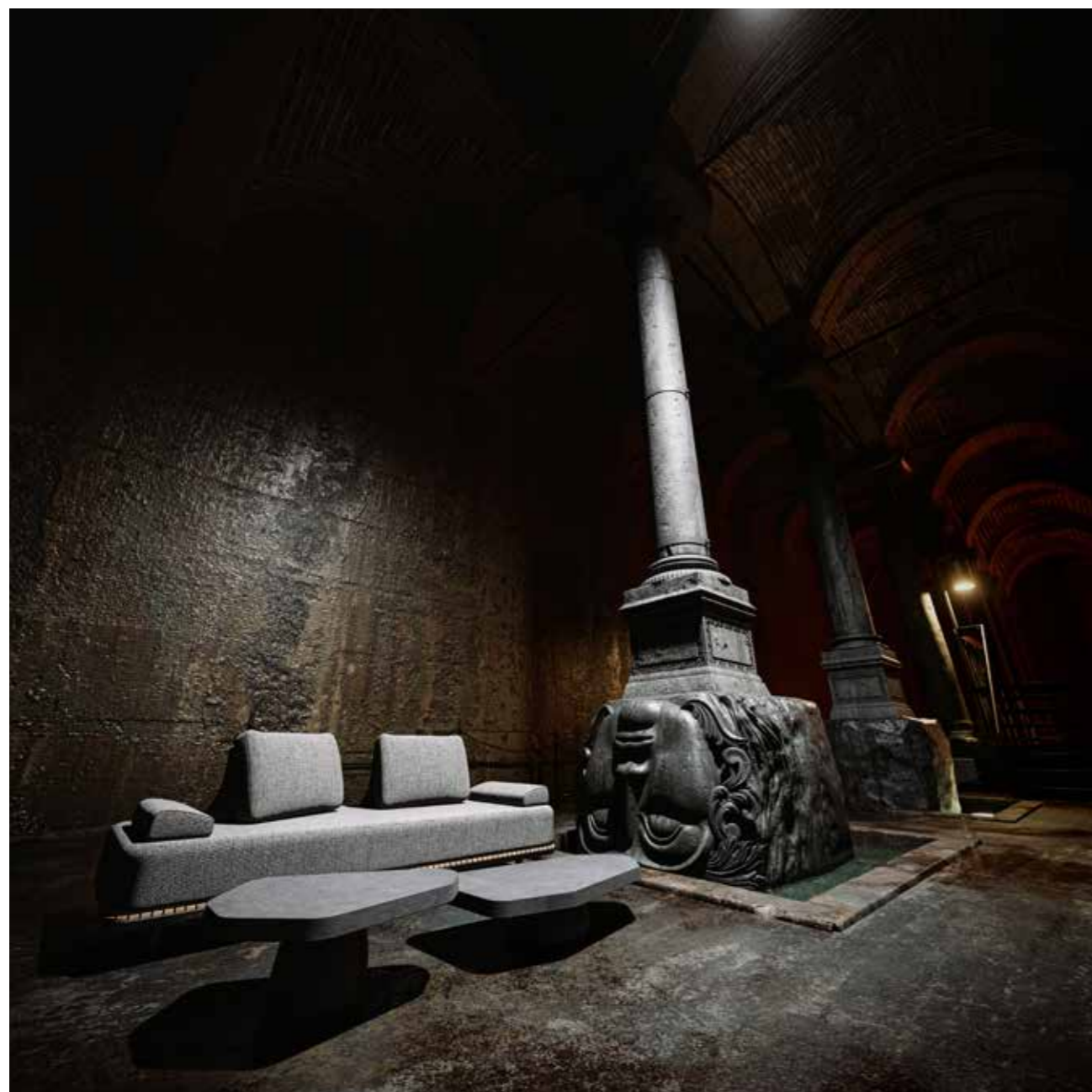

Medusa's beautiful hair to serpents and made her face so terrible to behold that the mere sight of it would turn on lookers to stone. According to the design perspective, it represents beauty, art and philosophy. Most often it is associated as a monster in whose eyes those who look into it will turn into stone.



MONUMENTAL

SCULPTURE

THREE-DIMENSIONAL ART OR ARCHITECTURE IS  
THE CREATED SPACE

"I went down the stairs with the landlady. I found myself in a forest of columns filled with water"  
PIERRE GILLES

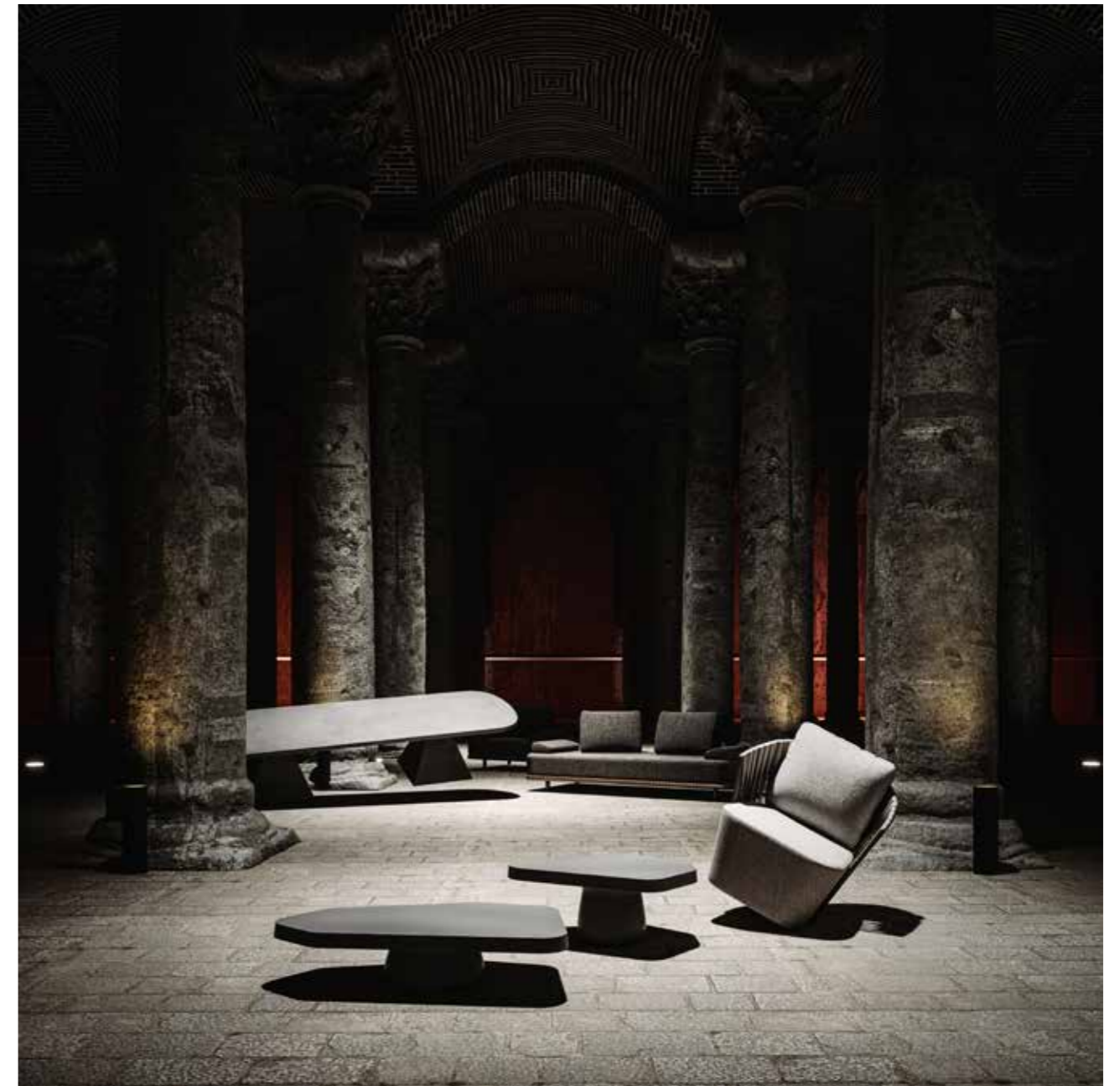

SNOC presents the Morgan Collection, which combines the function and structure with ergonomic details in perfect harmony. The meticulous and nature-sensitive stance of the collection embraces contemporary design principles. The masterful blend of different forms, functions, materials for the most comfortable use helps you experience the spirit of nature and stimulates your aesthetic perception.

SWAN

TURNS TO DARKNESS AS A MOTIF  
USING LIGHT AS THE DEFINING ELEMENT

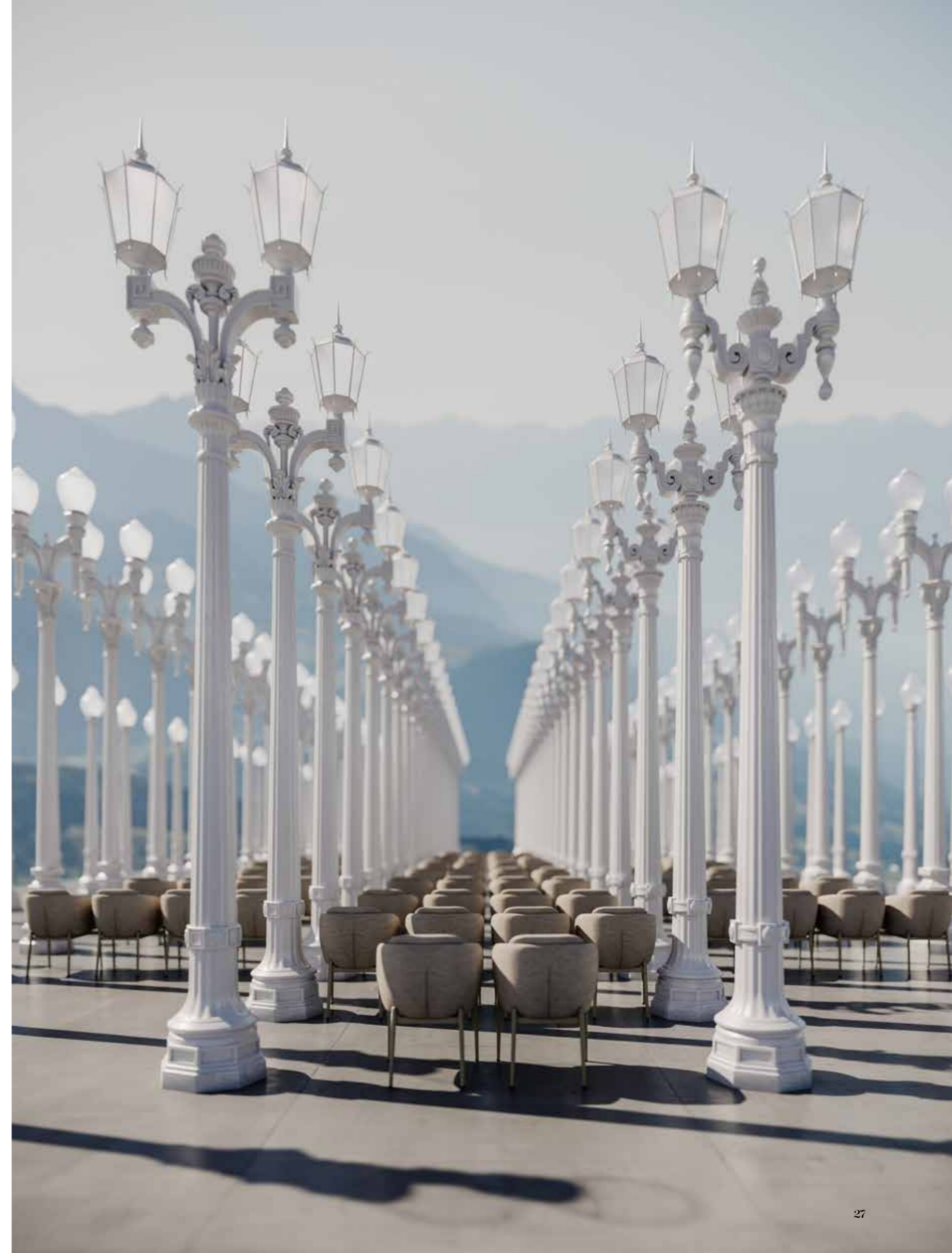





Public art installation and the sculptures in the light...

A central part of its mission to bring masterpieces of art and culture to the community and its holdings of Asian art. Latin American art to works by leading modern and contemporary artists; Islamic art of which hosts one of the most significant collections in the world.



THE URBAN LIGHTS ARE ICONIC PART OF AND ARE  
PARTICULARLY STUNNING AT DUSK

CONTINUOUS

SCULPTURES



Swan Collection creates a strong sense of contrast with its rounded form and strong lines. Symbolizing all the principles of modern design understanding, the collection makes the feeling of craftsmanship felt with contemporary style codes in synthetic rattan knitting details. The synthetic rattan knitting technique, which is made with high quality handwork that surrounds the U-shaped aluminum framed design, creates a unique aesthetic perception in which different materials combine elegance and character.

FINOL

REFLECTIVE TRANSPARENT TRANSLUCENT TACTILE

A N D

HERO OF DESIGN USED TO STRUCTURE







Palacio Barolo is representative of an impregnated dream foreshadowing architectural attitude, unique gestures and heroic ideals in spirit of "resurgence."



The aspirations to open the way to a new architecture, overcome the tensions that had reached the historical eclecticism. From a planning point of view, it is a unique piece that demonstrates the ability to combine creativity.

MATERIAL IS THE VOICE AS SPACE  
PASSES THROUGH THE FORMS



Finol Collection promises a refined aesthetic approach to outdoor compositions. The collection, dominated by versatile modern design principles, consists of corner set, dining set, chaise lounges and coffee tables. Each piece of the Finol Collection synthesizes the innovative design language with a high sense of comfort.

RALPH

STRUCTURE IS THE ART OF  
BALANCING AND CREATIVE VOICES



OBJECTS AND SPACES

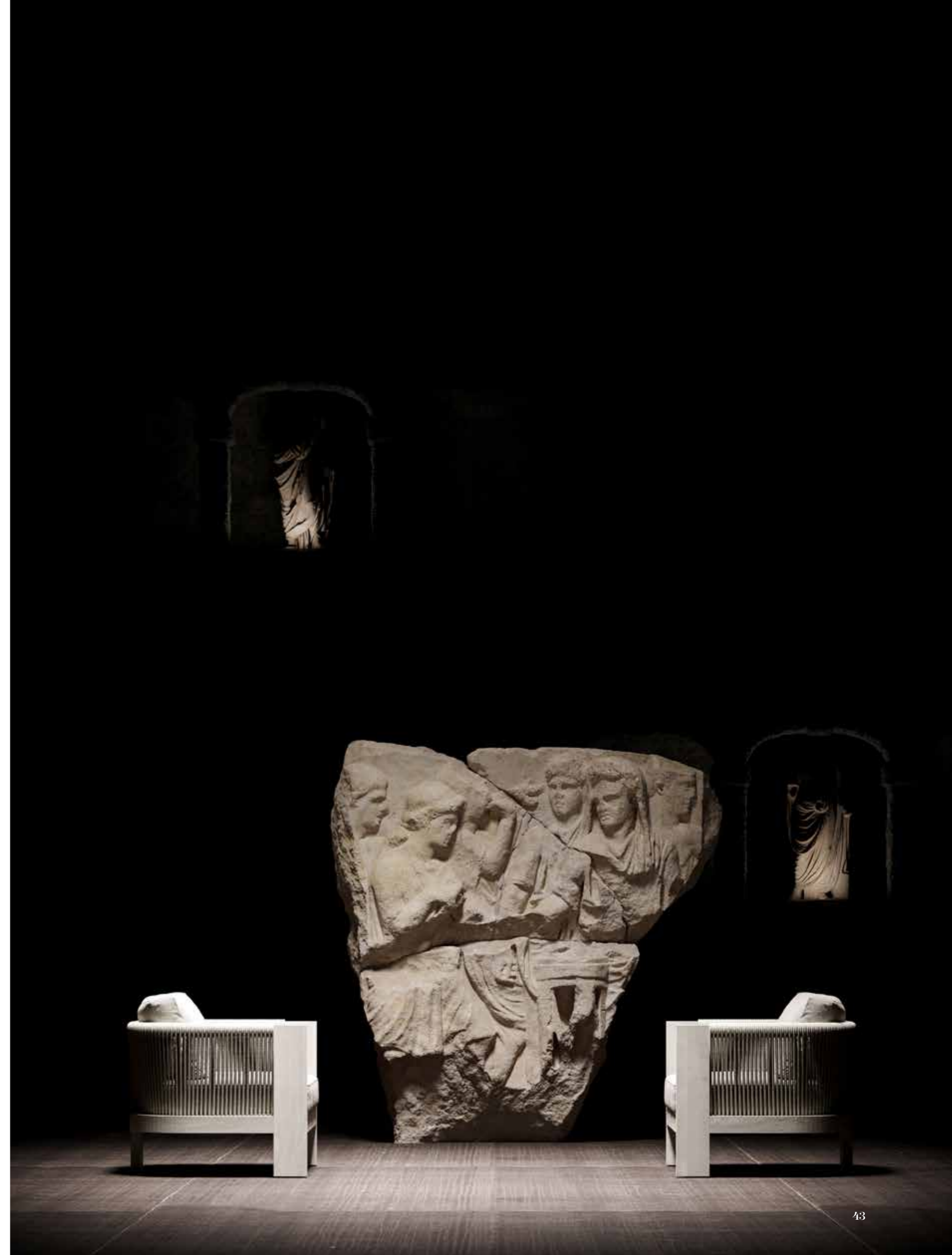



ATMOSPHERE

COMPOSITION



Music is a protean art; it lends itself easily to alliances with words as in song and with physical movement, this art a source of inspiration for the interpretation and understanding so it's a unique art form. Every location is carefully chosen to elevate the listening experience. Whether under the stars or in a venue with beautiful architecture.



RHYTHM AND MOVEMENT IN ART  
HUMAN SENSES AND INTELLECT

"It is not easy to determine the nature of music or why anyone should have a knowledge of it."  
-Aristotle

DESIGN OF FORM OR EMOTIONAL EXPRESSION



TIMES AND SPACES MAKE US WONDER  
RESONATE AND RADIATE SPIRIT



FROM POSTMODERNISM AND ANGLES

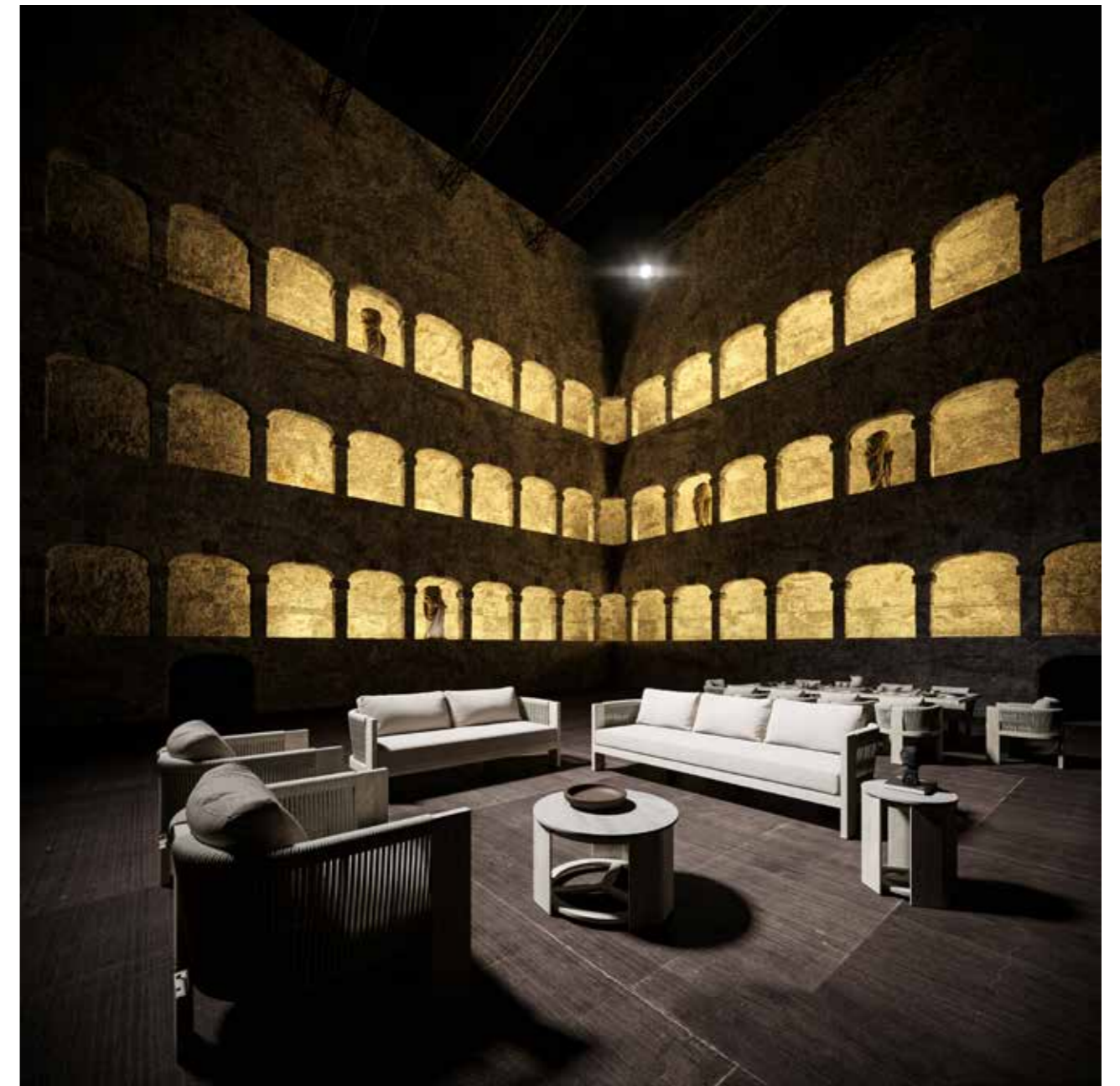

Ralph Collection consists of a lounge set, dining set, dining trolley, chaise lounge and coffee tables designed with teak wood and acrylic rope details that gracefully express a unique synthesis of aesthetics, functionality and ergonomics. The collection, which has turned into an iconic design, provides integrity in the perception of visual flow with framed design details, strong thick lines. It is enriched with cushion details in tones compatible with rustic solid teak color and offers a new and special interpretation to your outdoor areas.

PIGALLE

THE VARIOUS DESIGN ELEMENTS OF  
TRADITIONAL ARCHITECTURE. COUNTRY IN ART  
AND NATURAL LANDSCAPES

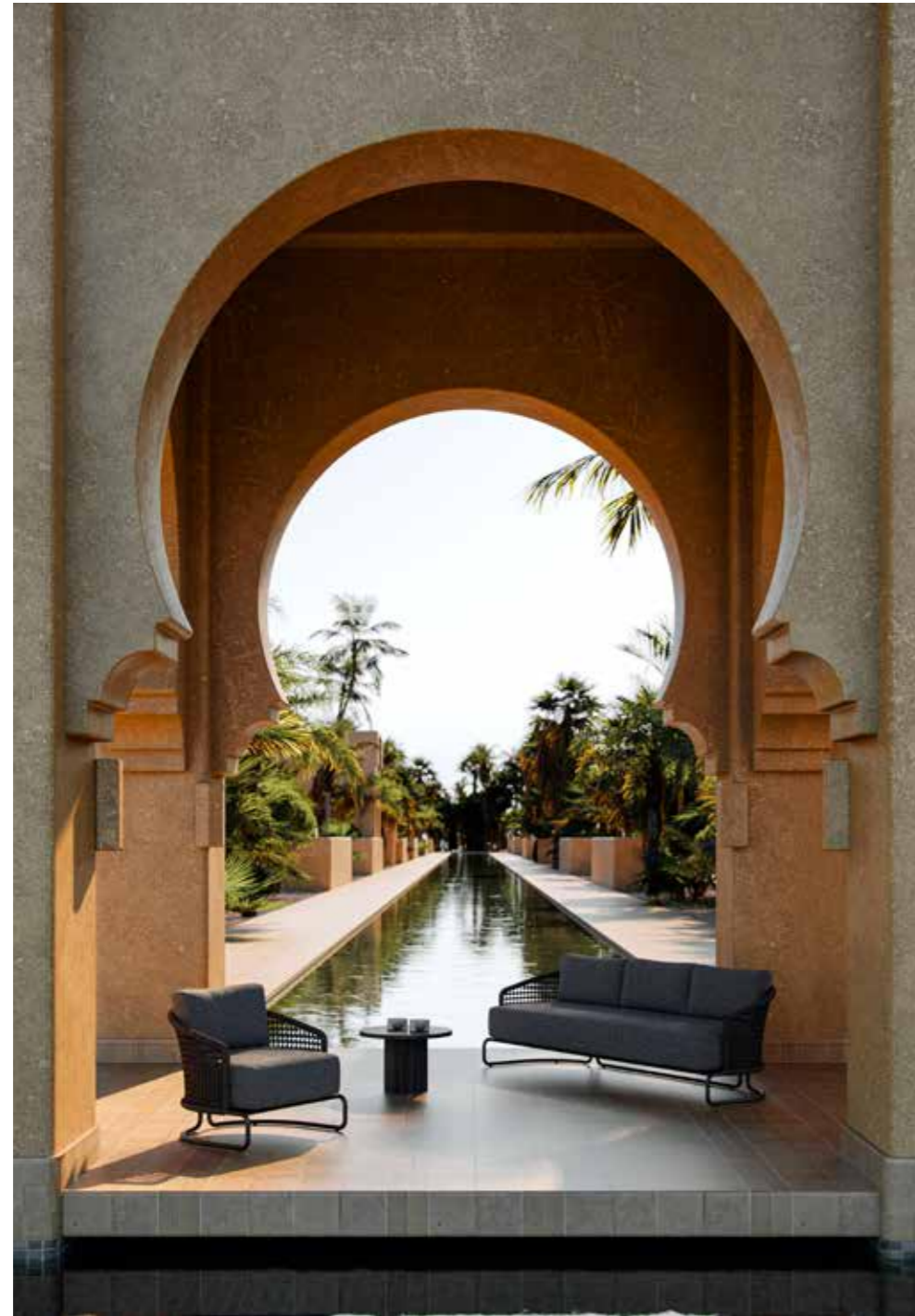

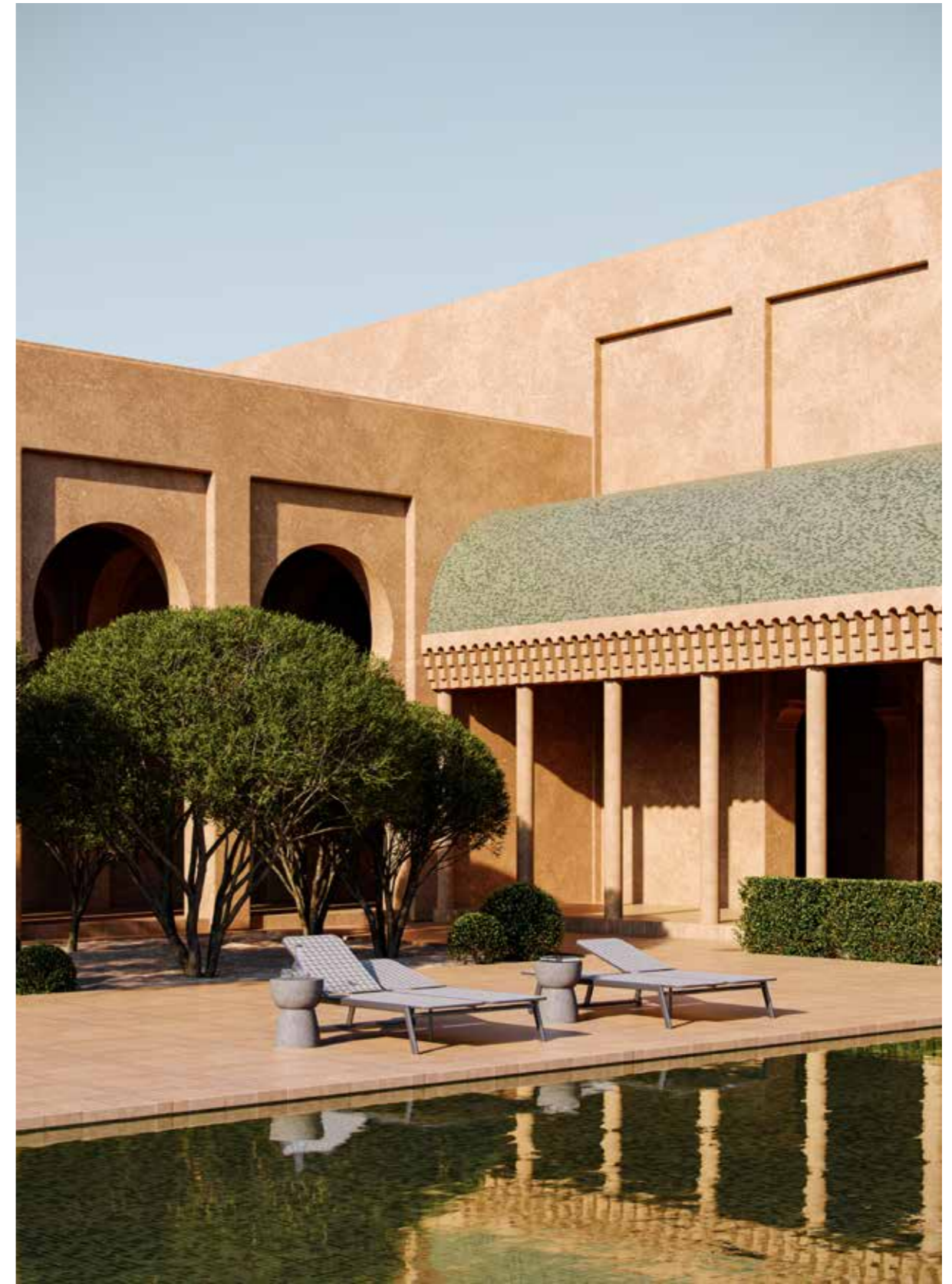
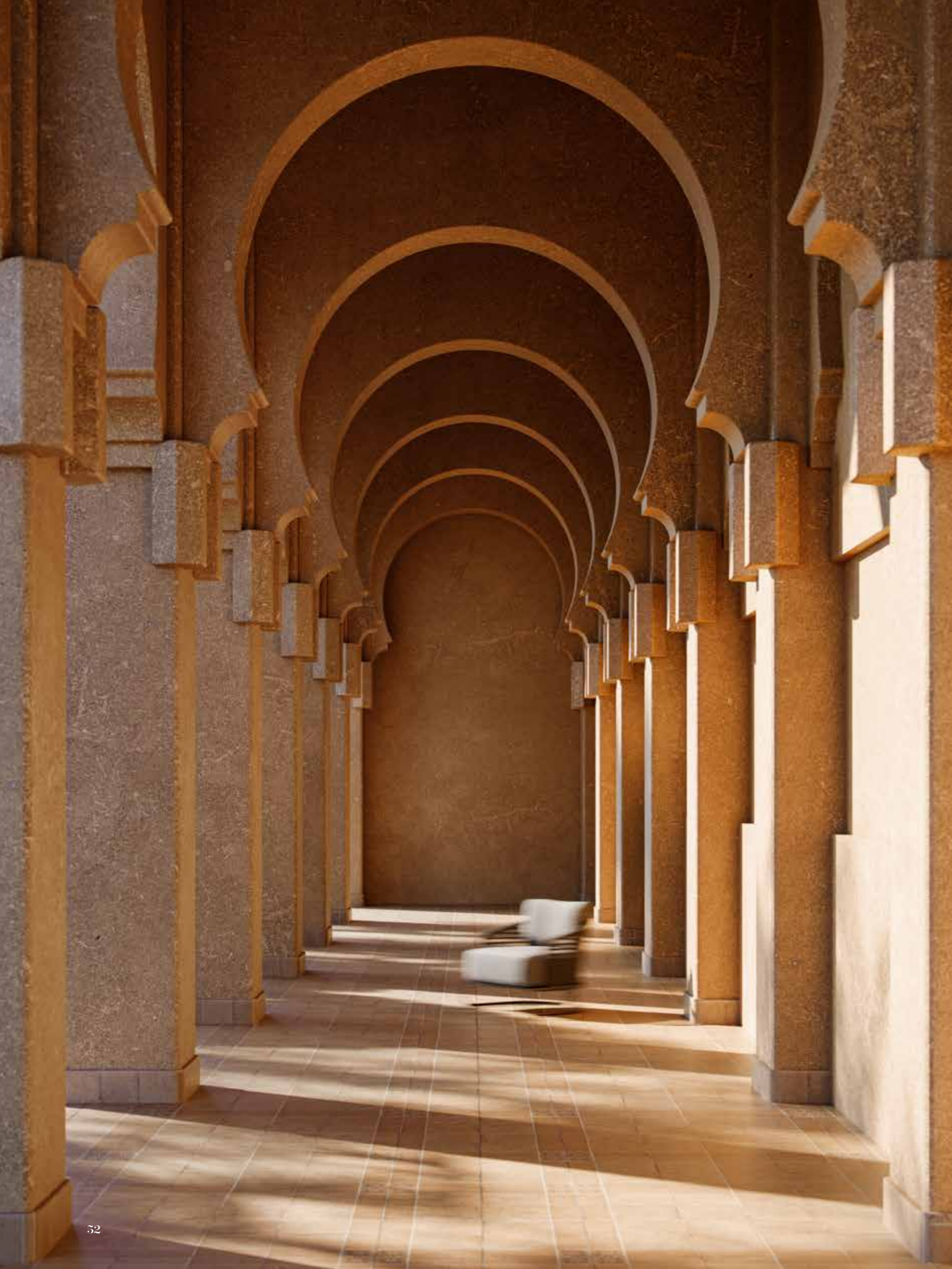

Morocco is often described as a country of allure, mystery and beauty and this is certainly in part due to its unique architecture. What sets Morocco's architecture apart is not only its exceptional blend of different design elements but also the unique features of each of its traditional buildings.



ARCHITECTURE OR THE ART OF CONSTRUCTION

IS IN ITS PRIMARY

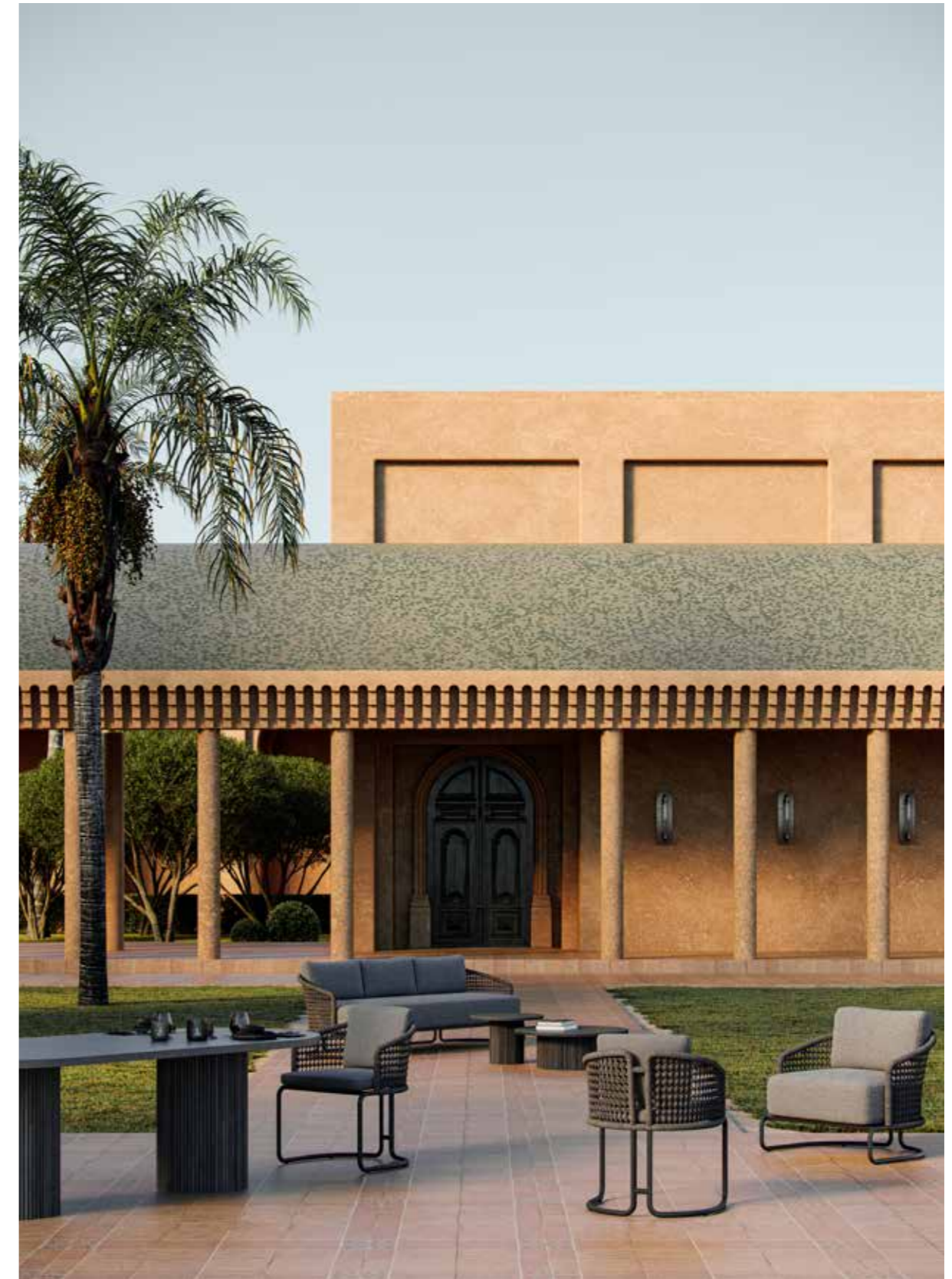

Pigalle Collection highlights the feeling of lightness and solidity with its aluminum skeleton structure, which characterizes timeless design and modern functionality in outdoor fictions. The round form of the collection, which consists of a lounge and dining set, integrates a contemporary design approach with simplicity

BAIXA

A R T

D E S I G N



CREATED  
AND

ELEGANCE  
NEW

OBJECTS  
SHAPES





DARK VIBES COMBINE TO CREATE  
AESTHETIC DESIGN



In dark places which combine high emotion an atmosphere of mystery and suspense Gothic theme so aesthetic of fear and haunting. "Gothic" is an amalgamation of two different ideas from history and it's certainly evoked many powerful emotions over the years.



GOTHIC ELEMENT IN THE



DESIGN  
LAYERS

OF



ICONIC

ASPECT  
SCENE





Baixa Collection balances its design approach that transcends time and space with a new generation of sustainable materials, aluminum and synthetic rattan. The collection, which consists of a lounge set, corner set, dining set reflect the high aesthetic perception of modern design to your outdoor spaces.

Argentina, Palacio Barolo



Austria, Felsenreitschule



Morocco, Marrakech



Turkey, Basilica Cistern



Saudi Arabia, Maraya Concert Hall



USA, Lacma Museum



Israel, Dibbuk at Gesher Theatre

